

1999. 4. 1. R.D

SC-502

1	FRONT PANEL	10	RUBBER STAND x 4
2	MAIN METAL BODY	11	POWER LED
3	TOP COVER (METAL)	12	POWER SUPPLY (50W)
4	AIR FILTER	13	POWER CONNECTOR (IN&OUT)
5	5.25" FULL-HIGH H.D.D	14	ID SWITCH
6	5.25" DRIVER-BAY (LEFT)	15	POWER SWITCH
7	5.25" DRIVER-BAY (RIGHT)	16	POWER CORD
8	SCSI CABLE	17	HEXAGON SCREW (6#32)
9	COOLING FAN	18	SCSI SCREW

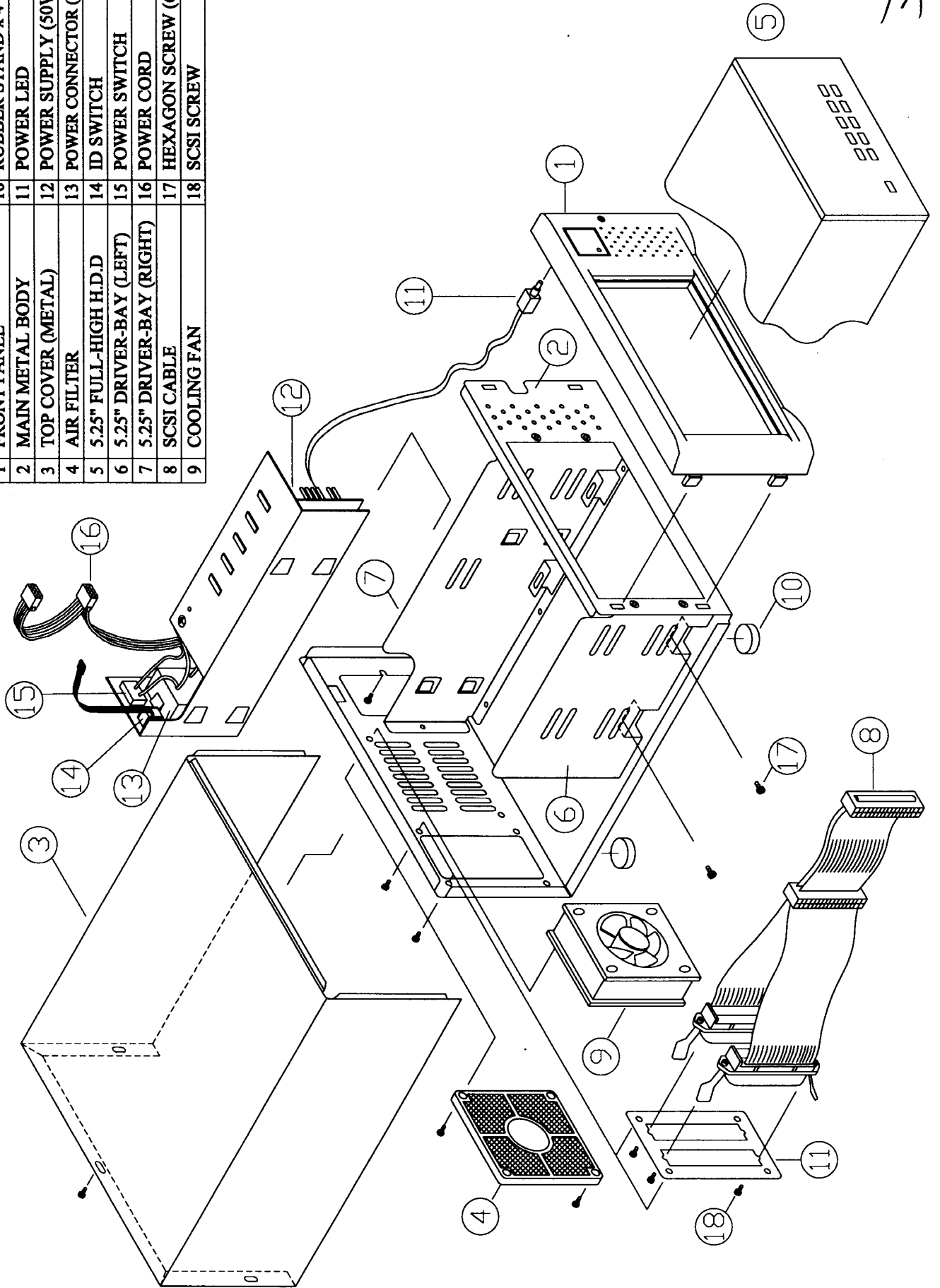

12/31